

# FOR LEASE - CBD OFFICE OPPORTUNITY

## EXECUTIVE BUILDING 811 SW SIXTH AVENUE PORTLAND, OREGON



### *Available Space in Suite 300*

- Approximately 9,020 RSF

### *Lease Rate*

- \$20.50 SF Full Service

### *Location*

- 811 SW Sixth Avenue

### *Features*

- Adjacent to Pioneer Courthouse Square
- Immediate Access to Public Transportation
- Proximity to Numerous Retail Services
  - Pioneer Square
  - Nordstroms
  - Macy's
  - Starbucks
  - Nike Town
  - Porto Tera
  - Hilton Hotel
  - On site Coffee Shop

For more information, please contact:

PETER DUNN  
503.279.1771  
Peter.Dunn@cushwake.com



200 SW Market, Suite 200, Portland, OR 97202  
503.279.1700 (phone) 203.279.1790 (fax)

# EXECUTIVE BUILDING

811 SW SIXTH AVENUE  
PORTLAND, OREGON

Suite 300  
9,020 RSF

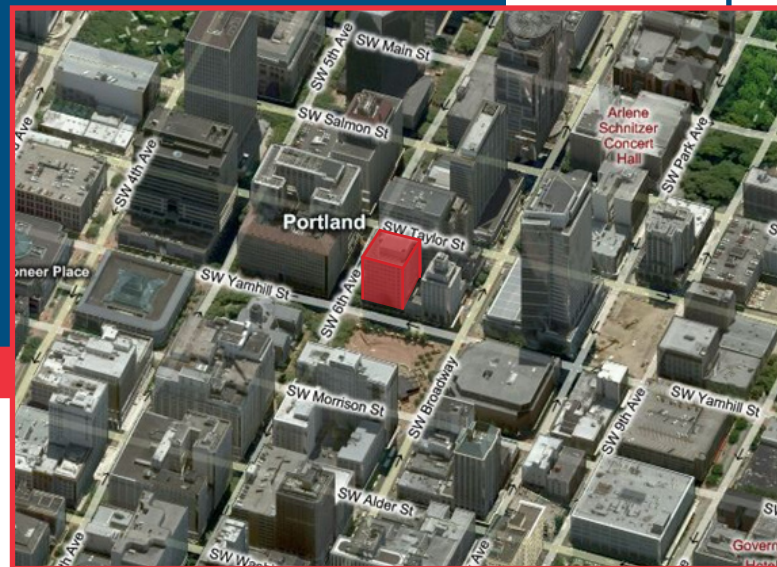
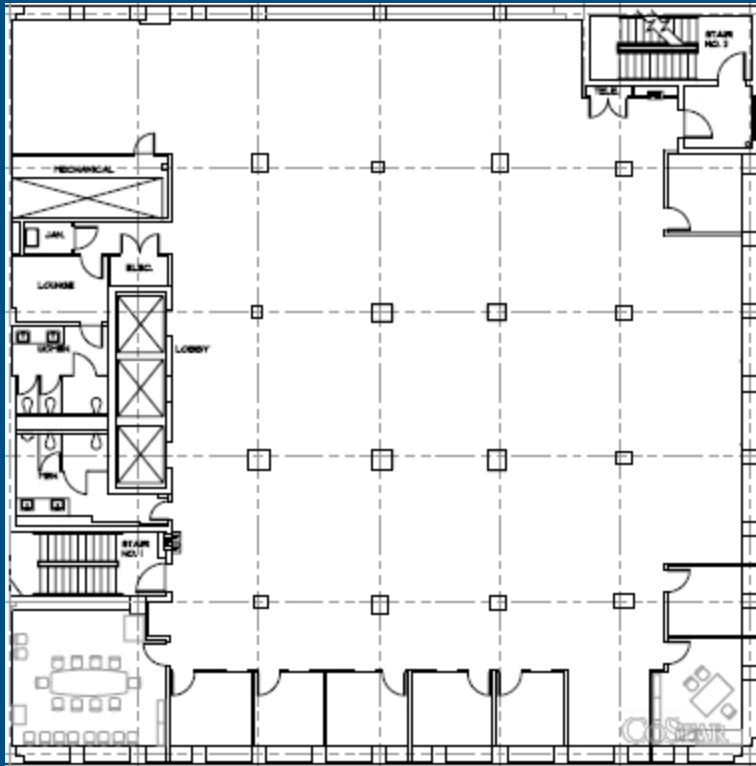

For more information, please contact:

PETER DUNN

503.279.1771

Peter.Dunn@cushwake.com



200 SW Market, Suite 200, Portland, OR 97202  
503.279.1700 (phone) 203.279.1790 (fax)