

**For Lease  
OFFICE**

# THE ROUND at Beaverton Central

4145 SW Watson Avenue  
Beaverton, OR 97005

## NEW OWNERSHIP



## Available:

### 24-Hour Fitness Building

▪ Suite 110	1,012 RSF
▪ Suite 200	5,417 RSF
▪ Suite 460*	2,456 RSF
▪ Suite 470*	2,888 RSF
▪ Suite 500	11,268 RSF

### Building D

▪ Suite 100	14,500 RSF
-------------	------------

\*Suites 460 and 470 can be combined for a total of 5,344 RSF

## Lease Rate:

\$19.75-\$22.50 per SF\*, Full Service

\*Subject to Buildout

## Location:

Centrally located in the heart of Beaverton

## Amenities:

- Easy access to Highway 217, Highway 26, Canyon Road, and Cedar Hills Boulevard
- 24-Hour Fitness, Mingo, Typhoon! and Mio Sushi on site
- MAX line service to your front door
- On-site property management
- Class A office environment
- Suburban park-like setting
- Private balconies

For more information or to schedule a tour, please contact:

### DERON JONES

503.279.1704  
deron.jones@cushwake.com

### LEE MORRISON

503.279.1742  
lee.morrison@cushwake.com

On Site:



**MINGO**



No warranty or representation, express or implied, is made as to the accuracy of the information contained herein, and same is submitted subject to errors omissions, change of price, rental or other conditions, withdrawal without notice, and to any specific listing conditions, imposed by our principals.

200 SW Market, Suite 200, Portland, OR 97201  
503-279-1700

**For Lease  
OFFICE**

# THE ROUND at Beaverton Central

4145 SW Watson Avenue  
Beaverton, OR 97005

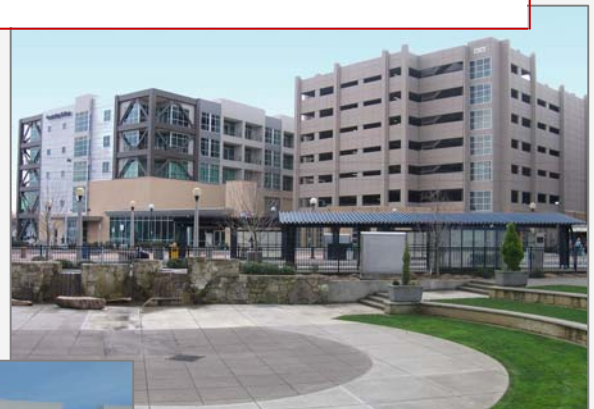
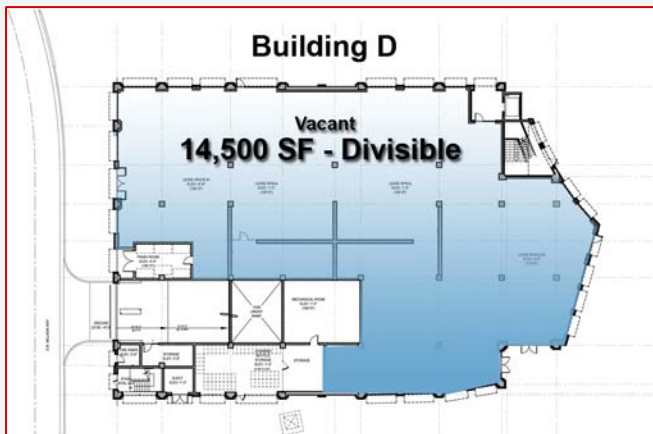
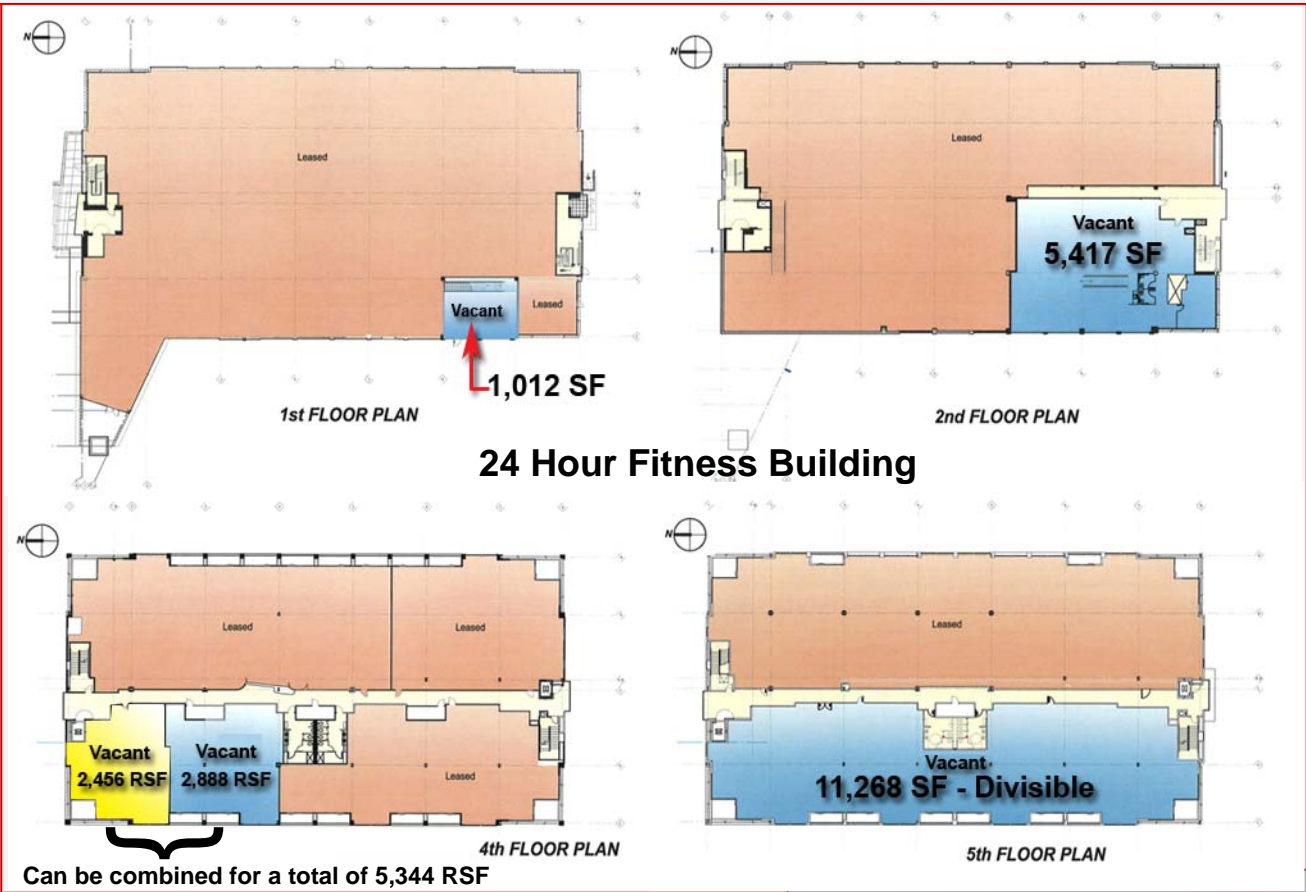

For more information or to schedule a tour, please contact:

**DERON JONES**  
503.279.1704  
deron.jones@cushwake.com

**LEE MORRISON**  
503.279.1742  
lee.morrison@cushwake.com

No warranty or representation, express or implied, is made as to the accuracy of the information contained herein, and same is submitted subject to errors omissions, change of price, rental or other conditions, withdrawal without notice, and to any specific listing conditions, imposed by our principals.



200 SW Market, Suite 200, Portland, OR 97201  
503-279-1700