



**CUSHMAN &
WAKEFIELD**

FOR SUBLEASE | 2,436 SF

Retail/Medical/Office

Near Burlingame Fred Meyer

7461 SW Barbur Blvd, Portland, OR 97219

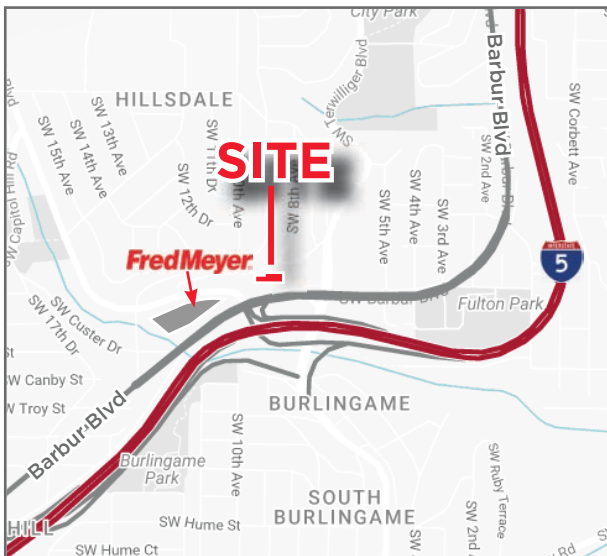

Property Highlights

- ★ Approximately 2,436 SF
- ★ Area tenants include: Fred Meyer, Starbucks, KFC, Taco Bell, Pizza Hut, Baja Fresh, Banfield Pet Hospital, Wells Fargo Bank, Chase Bank, US Bank, Kaady Car Wash
- ★ 5 treatment rooms; 2 ADA restrooms; 1 breakroom
- ★ 2 reserved parking spaces
- ★ Immediate access to I-5
- ★ Sublease opportunity through December 31, 2025
- ★ Call for rates

200 SW Market St, Suite 200
Portland, Oregon
main +1 503 279 1700
fax +1 503 279 1790
cushmanwakefield.com

Anne Hecht
Director, Retail
+1 503 279 1728
anne.hecht@cushwake.com

FOR SUBLEASE | 2,436 SF
 Retail/Medical/Office
 Near Burlingame Fred Meyer
 7461 SW Barbur Blvd



FLOOR PLAN

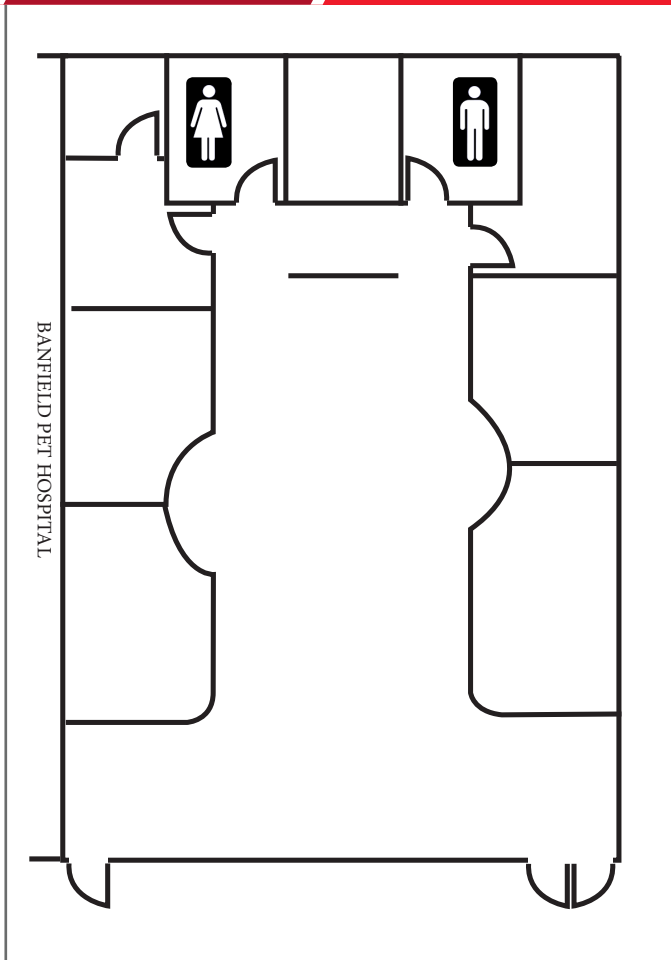

SITE PLAN

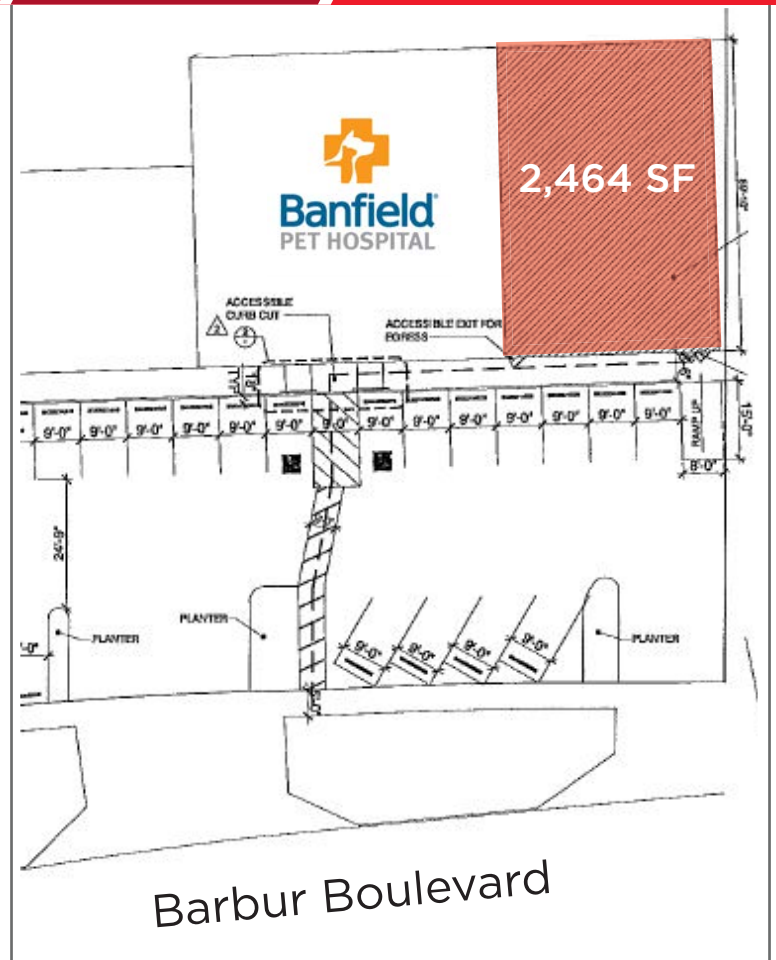

Anne Hecht
 Director, Retail
 +1 503 279 1728
 anne.hecht@cushwake.com

200 SW Market St, Suite 200
 Portland, Oregon
 main +1 503 279 1700
 fax +1 503 279 1790
cushmanwakefield.com

Demographics	1 Miles	3 Mile	5 Miles
Population	13,072	112,454	376,296
Households	6,148	51,436	178,290
Avg HH Income	\$111,307	\$112,625	\$94,181

Cushman & Wakefield Copyright 2018. No warranty or representation, express or implied, is made to the accuracy or completeness of the information contained herein, and same is submitted subject to errors, omissions, change of price, rental or other conditions, withdrawal without notice, and to any special listing conditions imposed by the property owner(s). As applicable, we make no representation as to the condition of the property (or properties) in question.