

For Lease **RETAIL**

THE ROUND at Beaverton Central

12600 SW Crescent Street
Beaverton, OR 97005



Join co-tenants 24-Hour Fitness, Mingo, Typhoon! and Mio Sushi at The Round in the heart of Beaverton

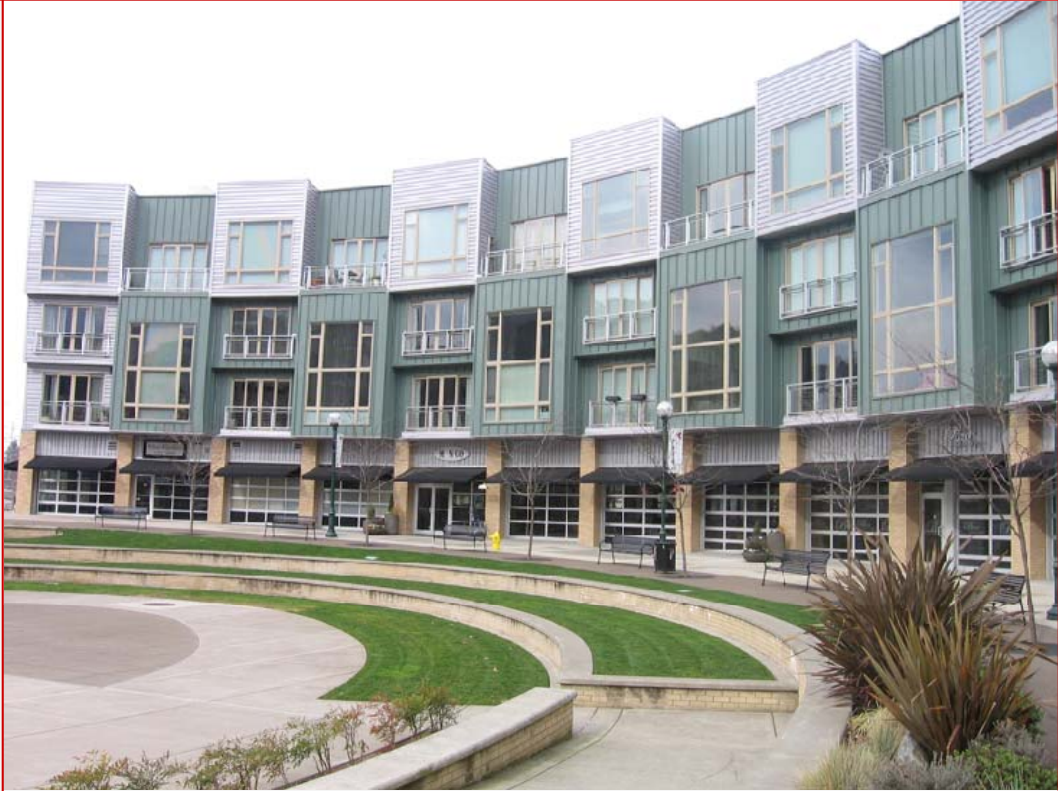

Available:

Building D / Parking Structure	
▪ Suite 100	14,500 SF
Crescent / Promenade Buildings	
▪ Suite 110	2,021 SF
▪ Suite 130	3,119 SF
▪ Suite 160*	2,499 SF
▪ Suite 180*	1,881 SF
▪ Suite 190*	3,800 SF

Leased

- Easy access to Highway 217, Highway 26, Canyon Road, and Cedar Hills Boulevard
- MAX line service to your front door
- On-site property management
- Suburban park-like setting
- Office campus
- Free parking

Rates:

- **\$20.00-\$22.00 per Square Foot NNN**

For more information and inspection please contact:
ANNE HECHT
503.279.1728
anne.hecht@cushwake.com

*Suites can be combined for a total of 8,180 contiguous SF



No warranty or representation, express or implied, is made as to the accuracy of the information contained herein, and same is submitted subject to errors omissions, change of price, rental or other conditions, withdrawal without notice, and to any specific listing conditions, imposed by our principals 5/6/2011.

For Lease **RETAIL**

THE ROUND at Beaverton Central

12600 SW Crescent Street
Beaverton, OR 97005

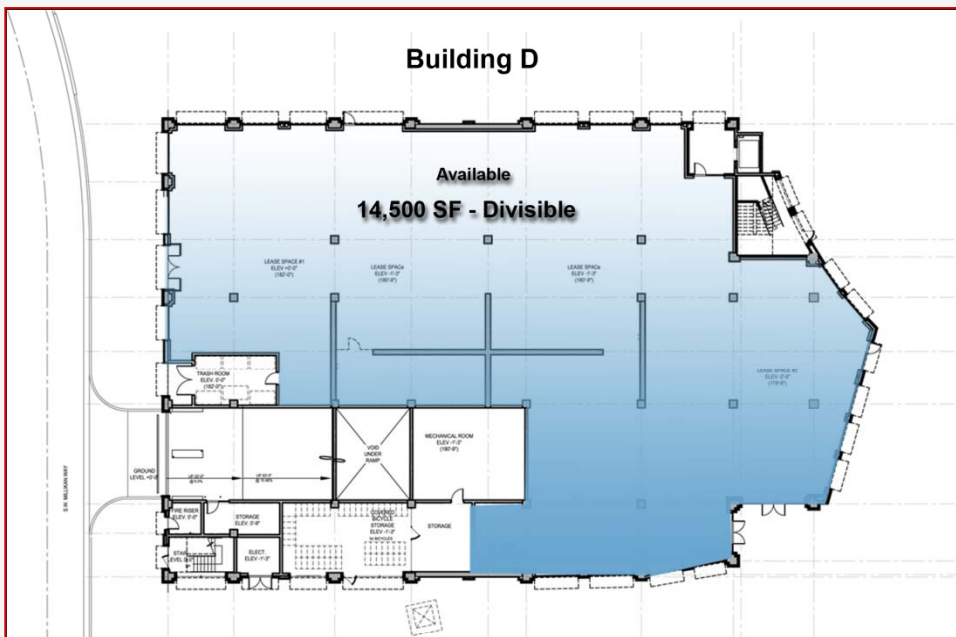
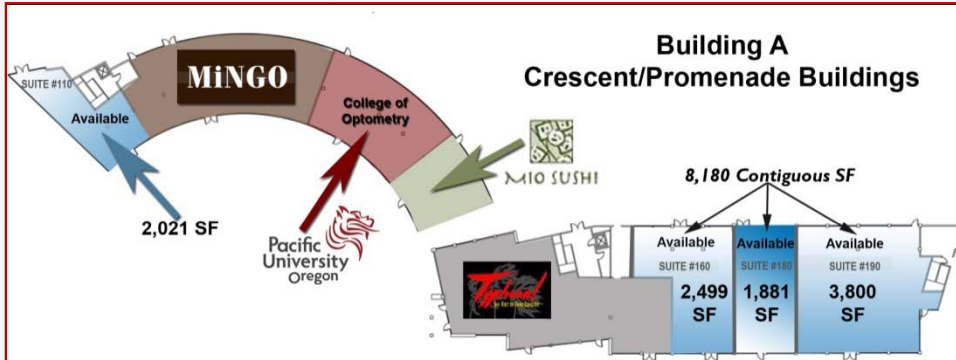

For Lease RETAIL

THE ROUND at Beaverton Central

12600 SW Crescent Street
Beaverton, OR 97005



For Lease **RETAIL**

THE ROUND at Beaverton Central

12600 SW Crescent Street
Beaverton, OR 97005



MAX LINE SERVICE TO YOUR DOOR

The collage features several key elements: a blurred train in motion, a large fountain with multiple jets of water, a detailed transit map showing the MAX line from Hillsboro to Gresham with various stations and zones, a transit station sign for Beaverton Central, and two photographs of the building's exterior from different angles.

For more information and inspection please contact:

ANNE HECHT
503.279.1728
anne.hecht@cushwake.com



No warranty or representation, express or implied, is made as to the accuracy of the information contained herein, and same is submitted subject to errors omissions, change of price, rental or other conditions, withdrawal without notice, and to any specific listing conditions, imposed by our principals. 5/6/2011

200 SW Market, Suite 200, Portland, OR 97201
503-279-1700